

STAGE 1
 GREENSCREEN STAGE
 THE O'CONNOR BUILDING

1,100 Square Feet
 Height - 16'
 Greenscreen: 22' X 22' X 12' tall
 Power - 100 Amps, 3-Phase
 Quiet A/C - 20 Tons
 Loading Door - 6' x 7'

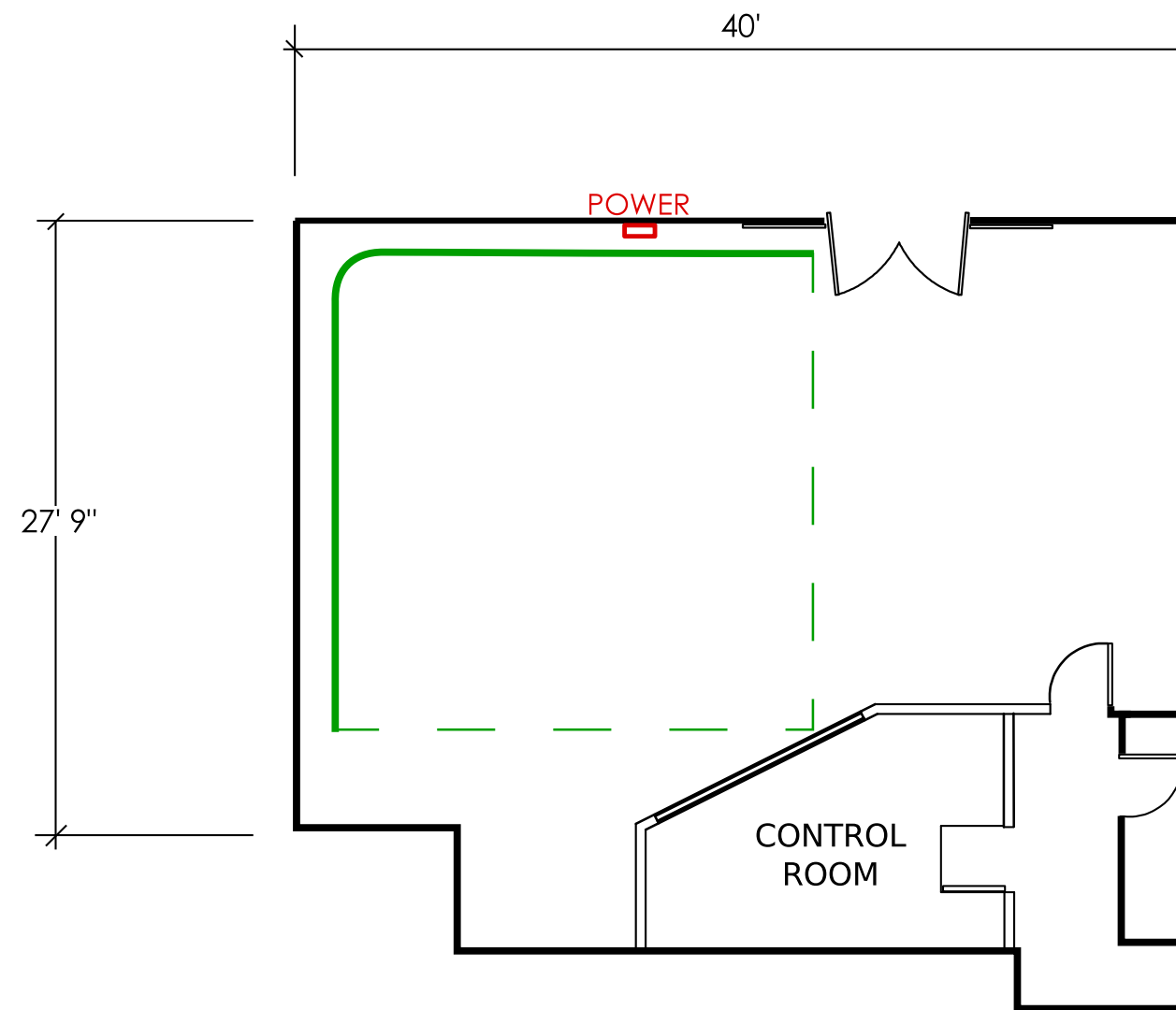

CELTIC MEDIA CENTRE RALEIGH STUDIOS BATON ROUGE	
STAGE 1	1/8" = 1'