

Celtic

MEDIA CENTRE

10000 Celtic Drive
Baton Rouge, LA 70809
T: 225.330.6000 / F: 225.330.6163
Toll-Free: 888.49.MOVIE
info@celticmediacentre.com

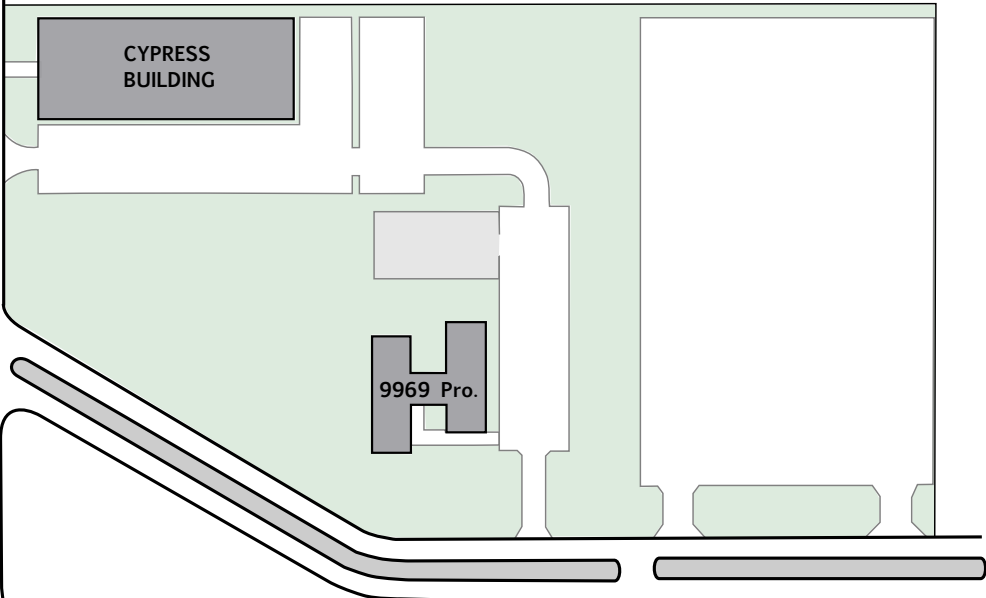
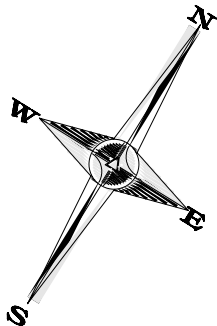

Revised:
01/01/2014

STAGES

STAGE SPECIFICATIONS						
STAGE	SQ. FT.	DIMENSIONS	CLEARANCE	3Ø 208v POWER	WEIGHT LOAD	QUIET A/C
1 / GREENSCREEN	1,100	27'9" x 40'	16'	100 Amps	N/A	20 Tons
2	6,500	63' x 104'	28'	800 Amps	1,500 lbs. / Grid Points	65 Tons
4	30,800	140' x 220'	36' Eave, 54.5' Center	2,000 Amps	15,000 lbs. / Rafter	200 Tons
5	27,600	134' x 206'	45' Eave, 70' Center	1,600 Amps	10,000 lbs / Rafter	240 Tons
6	30,800	140' x 220'	36' Eave, 54.5' Center	2,000 Amps	15,000 lbs. / Rafter	200 Tons
7 / MILL	22,500	131' x 176'	36' Eave, 53.5' Center	1,600 Amps	15,000 lbs. / Rafter	N/A
8	28,650	125' x 250'	29.5' Rear, 29.5' Front	1,600 Amps	10,000 lbs / Rafter	210 Tons

OFFICES

OFFICE BUILDINGS			
BUILDING	SQ. FT.	BUILDING AMENITIES	LOT-WIDE AMENITIES
O'CONNOR	37,650	CLASS-A INDIVIDUAL SUITES, SCREENING ROOM, ADR STUDIO, GREEN ROOM, COMMISSARY	FIBER HIGH-SPEED INTERNET AND CAMPUS FIBER NETWORK, DIGITAL PHONE SYSTEM, ADJOINED BUILDING PARKING
OAK TREE	25,000	CLASS-A INDEPENDENT OR JOINABLE SUITES	
CYPRESS	16,200	CLASS-A INDEPENDENT OR JOINABLE SUITES	
COTTAGE	3,044	CLASS-A EDITING BUILDING, FIBER AND ETHERNET TO EACH SUITE	
9969 PRO.	8,235	CLASS-A VISUAL FX BUILDING, SCREENING ROOM	

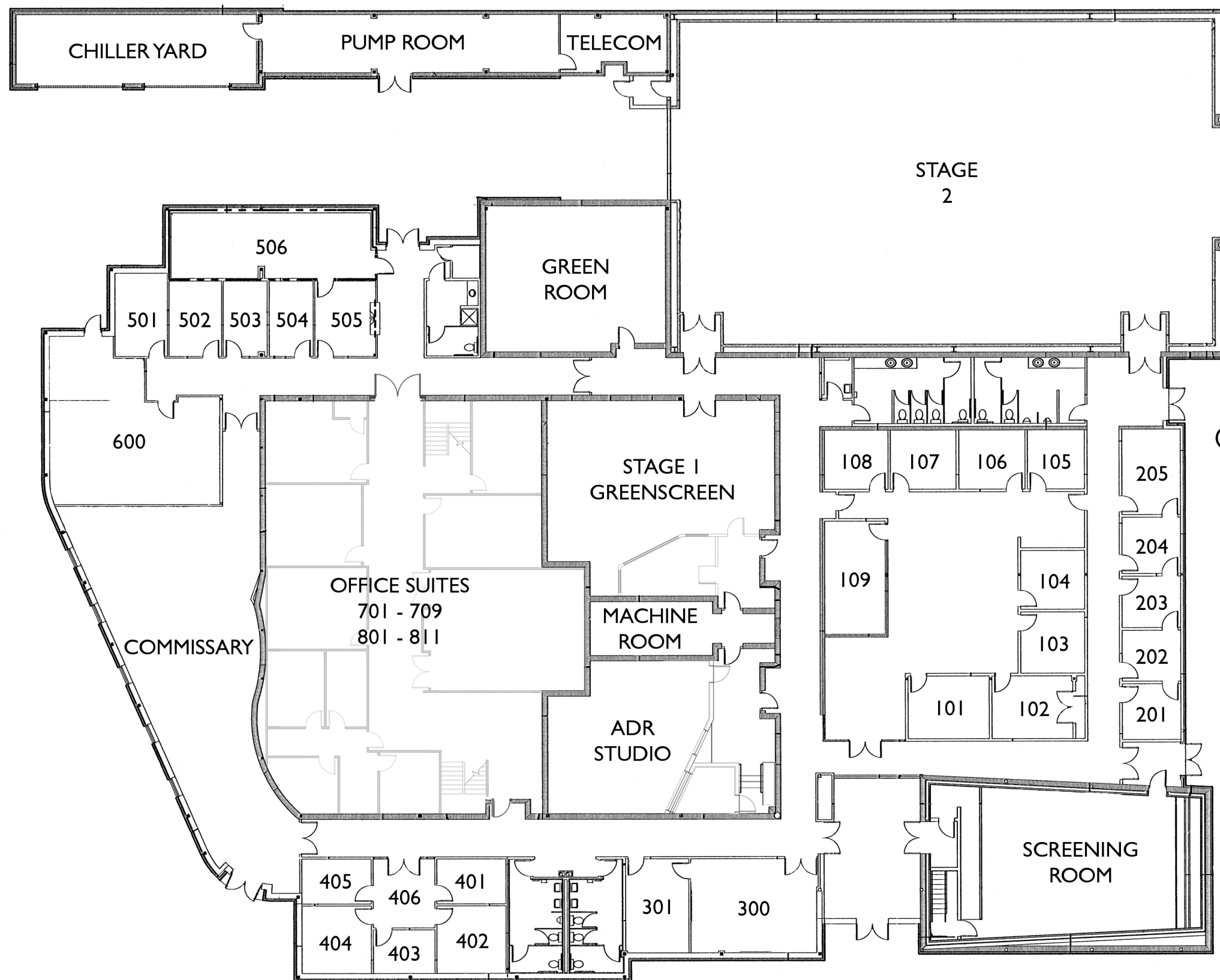

THE O'CONNOR BUILDING OFFICES, STAGES, POST-PRODUCTION

37,650 Square Feet
 Class-A Office Space
 50-Seat Screening Room
 ADR Studio
 Stages 1 and 2
 Green Room
 Commissary
 Fiber High-Speed Internet and
 Campus Fiber Network
 Digital Phone System



Celtic
 MEDIA CENTRE

O'CONNOR

3/64" = 1'

STAGE 1
GREENSCREEN STAGE
THE O'CONNOR BUILDING

1,100 Square Feet
Height - 16'
Greenscreen: 22' X 22' X 12' tall
Power - 100 Amps, 3-Phase
Quiet A/C - 20 Tons
Loading Door - 6' x 7'

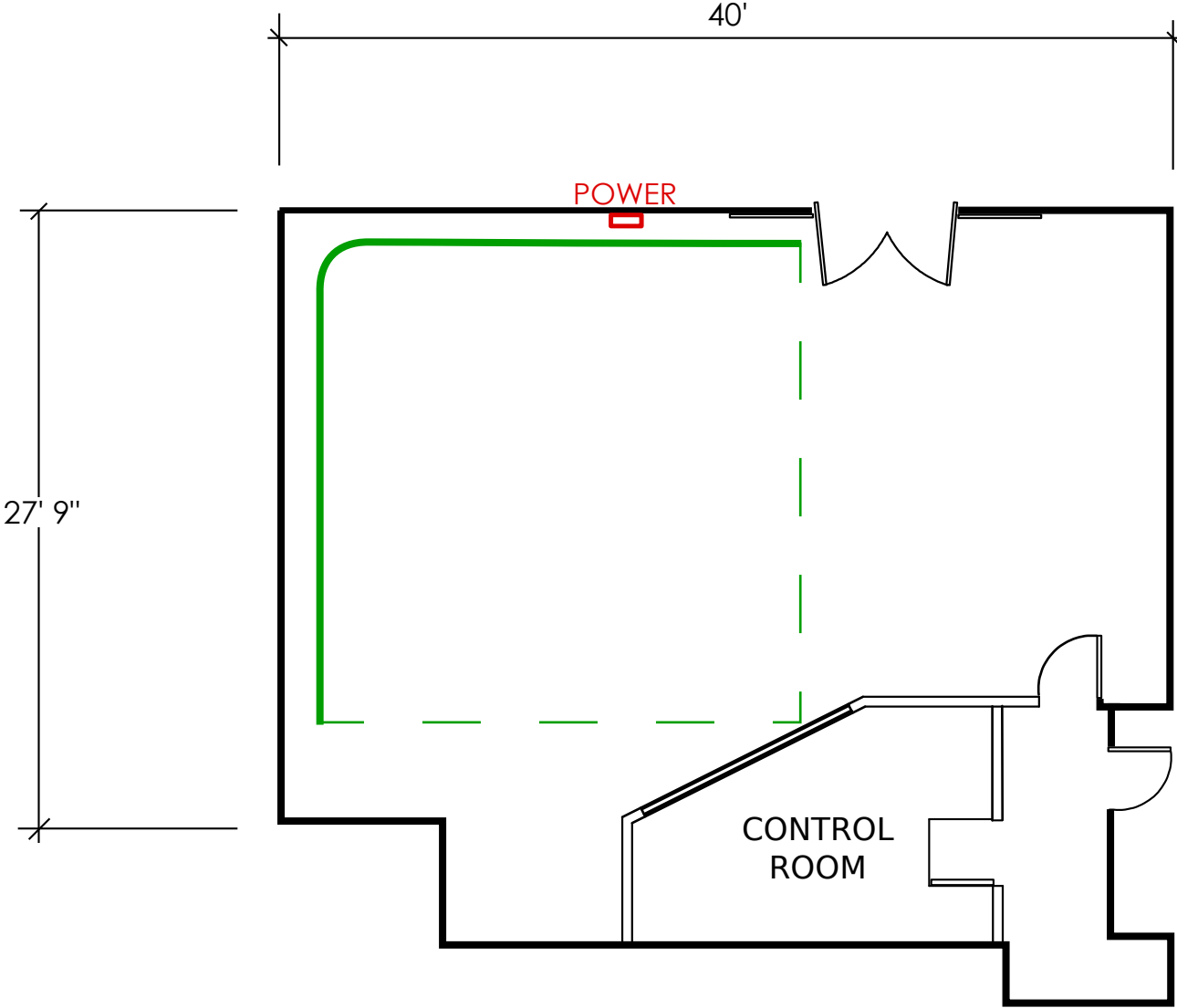

STAGE 1

1/8" = 1'

STAGE 2
THE O'CONNOR BUILDING

6,500 Square Feet
Height - 28'
Power - 800 Amps, 3-Phase
Grid Point Load: 1,500 lbs.
Quiet A/C - 65 Tons
Door - 17' x 17'
Trailer Hookups - 4

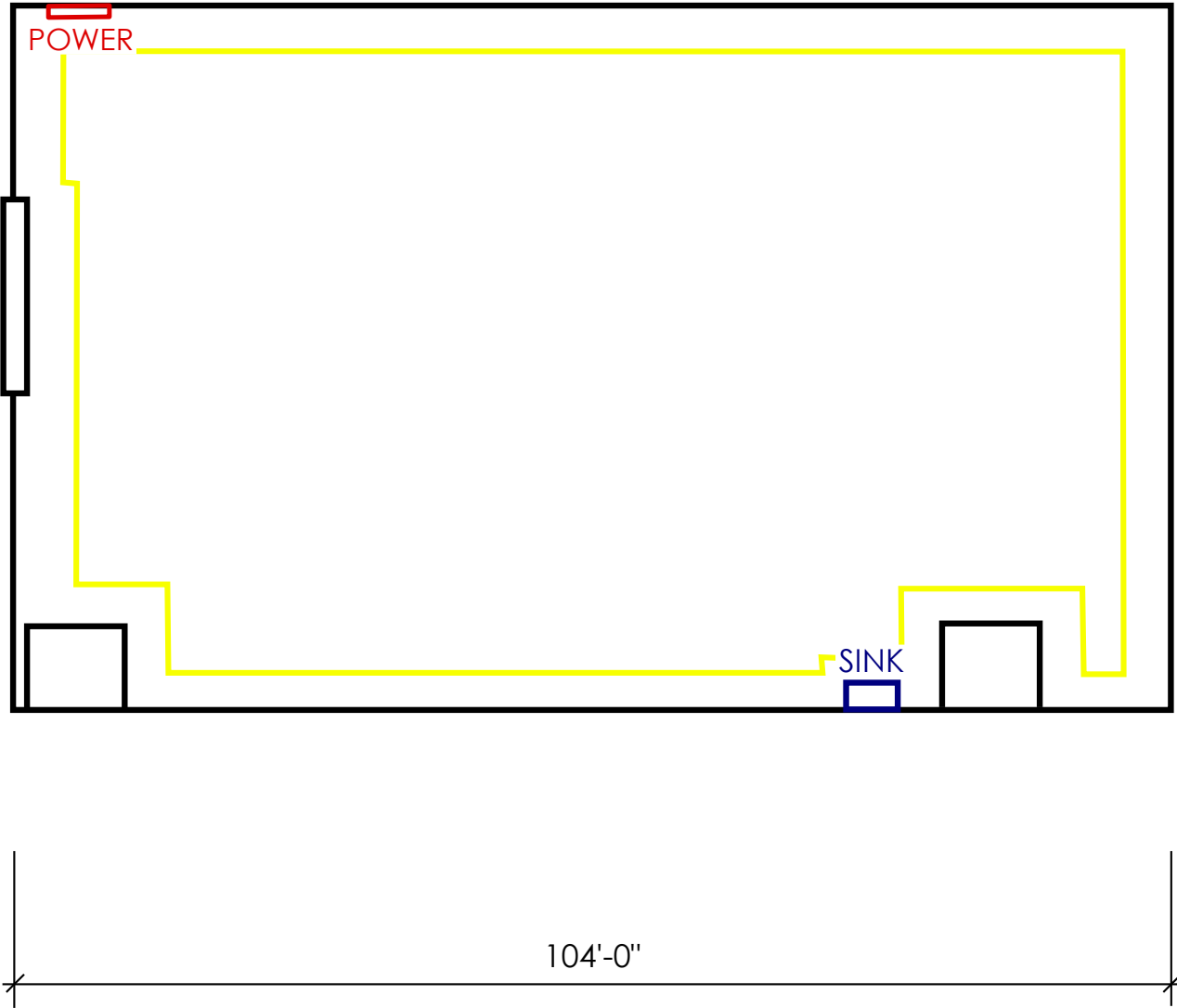

Fire Lane = 5' from walls
Area Inside Fire Lane = 4,800 Sq. Ft.



STAGE 2

1/16" = 1'

STAGE 4
THE BRIANNA BUILDING

30,800 Square Feet
Clearance - 36' Sides, 54.5' Center
Power - 2000 Amps, 3-Phase
Rafter Load: 15,000 lbs.
Quiet A/C - 200 Tons
Doors - 2, 16' x 20'

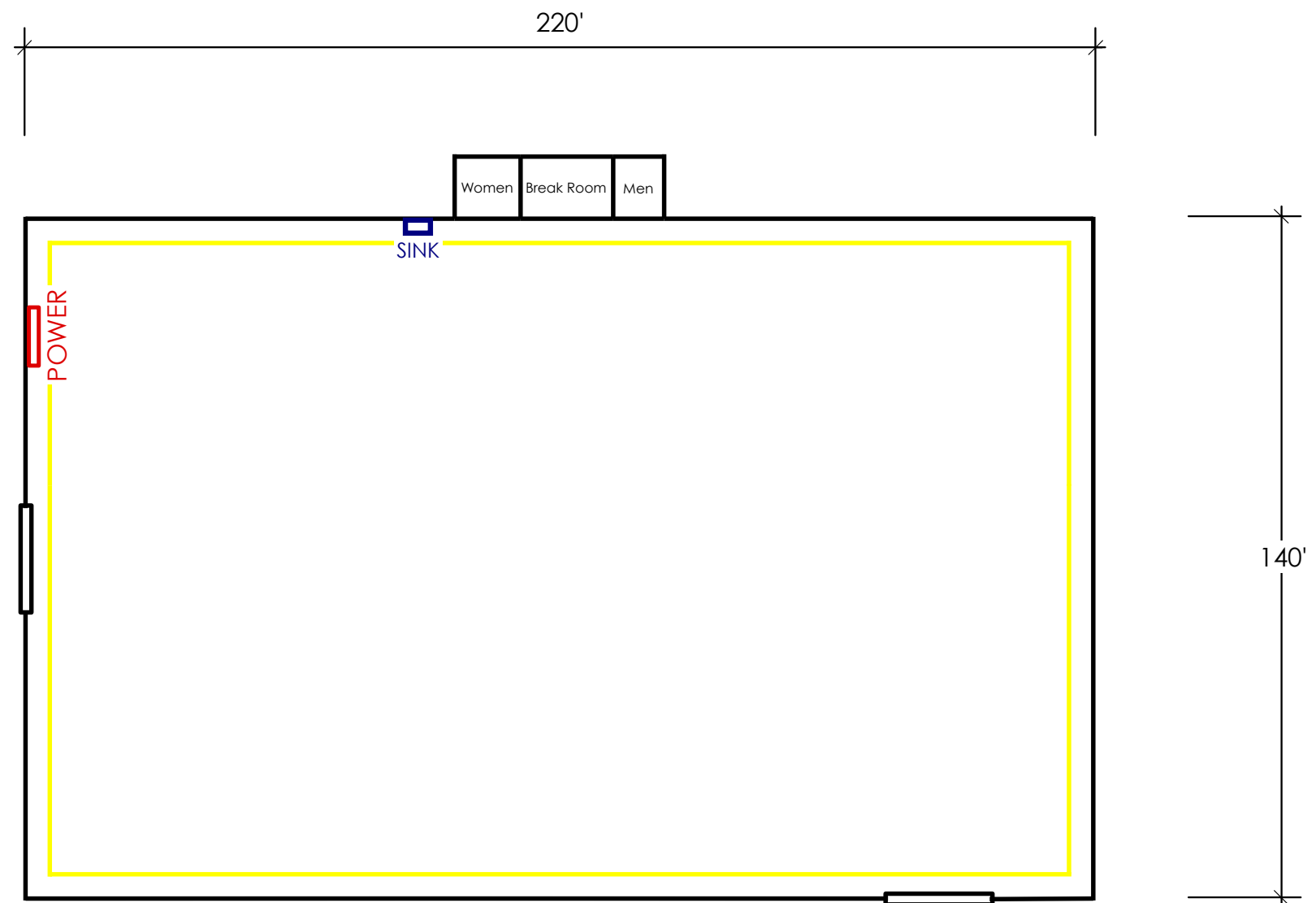

Fire Lane = 5' from walls
Area Inside Fire Lane = 27,300 Sq. Ft.



STAGE 4

1/32" = 1'

STAGE 5
THE REBECCA BUILDING

27,600 Square Feet
Clearance - 45' Sides, 70' Center
Power - 1600 Amps, 3-Phase
Rafter Load: 10,000 lbs.
Quiet A/C - 240 Tons
Doors - 2, 20' x 20'
Trailer Hookups - 4

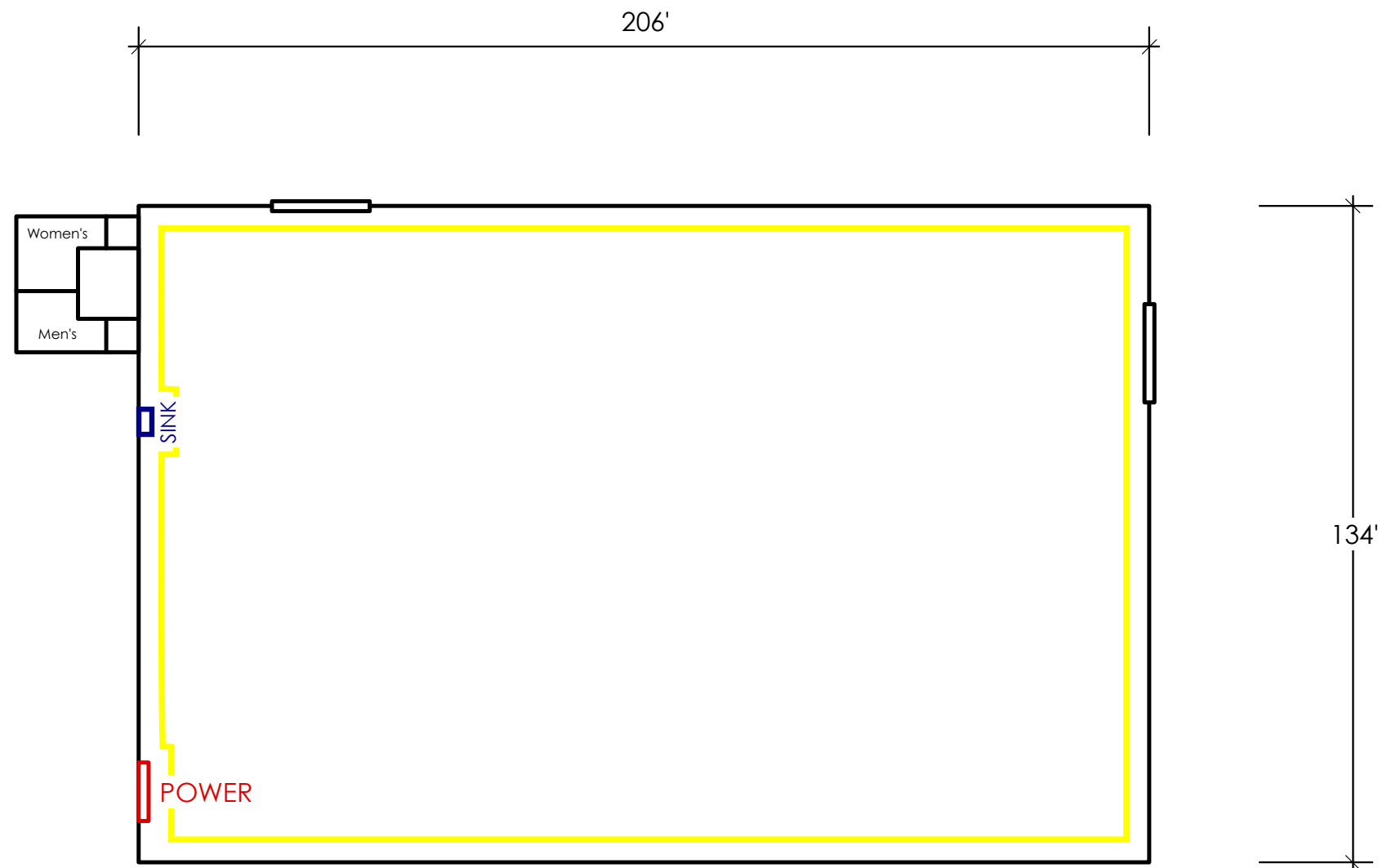

Fire Lane = 5' from walls
Area Inside Fire Lane = 24,300 Sq. Ft.



STAGE 5

1/32" = 1'

STAGE 6
THE CAITLIN BUILDING

30,800 Square Feet
Clearance - 36' Sides, 54.5' Center
Power - 2000 Amps, 3-Phase
Rafter Load: 15,000 lbs.
Quiet A/C - 200 Tons
Doors - 2, 16' x 20'

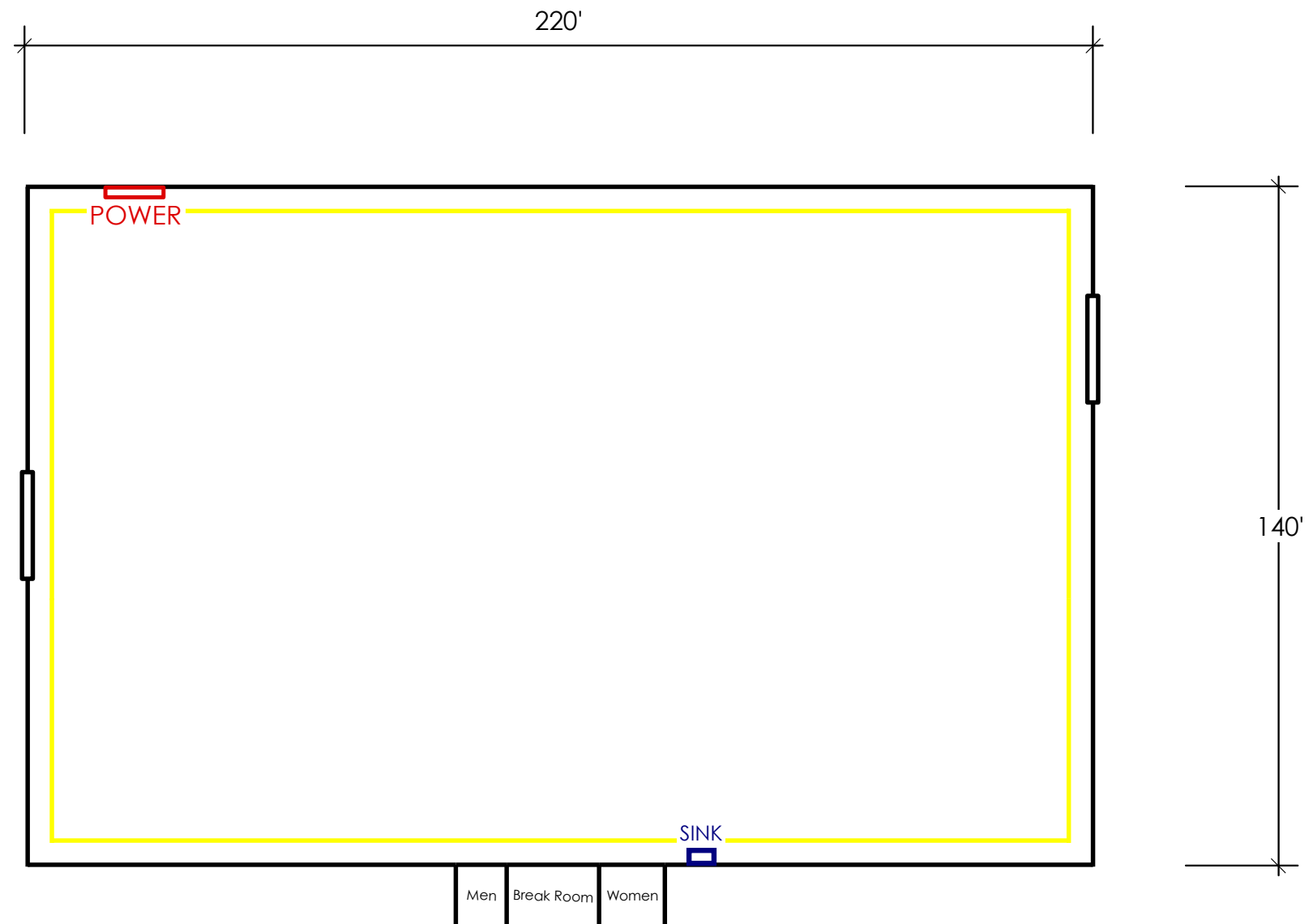

Fire Lane = 5' from walls
Area Inside Fire Lane = 27,300 Sq. Ft.



STAGE 6

1/32" = 1'

STAGE 7
THE ALISA BUILDING

22,500 Square Feet
Clearance - 36' Sides, 53.5' Center
Power - 1600 Amps, 3-Phase
Rafter Load: 15,000 lbs.
Doors - 2, 16' x 20'

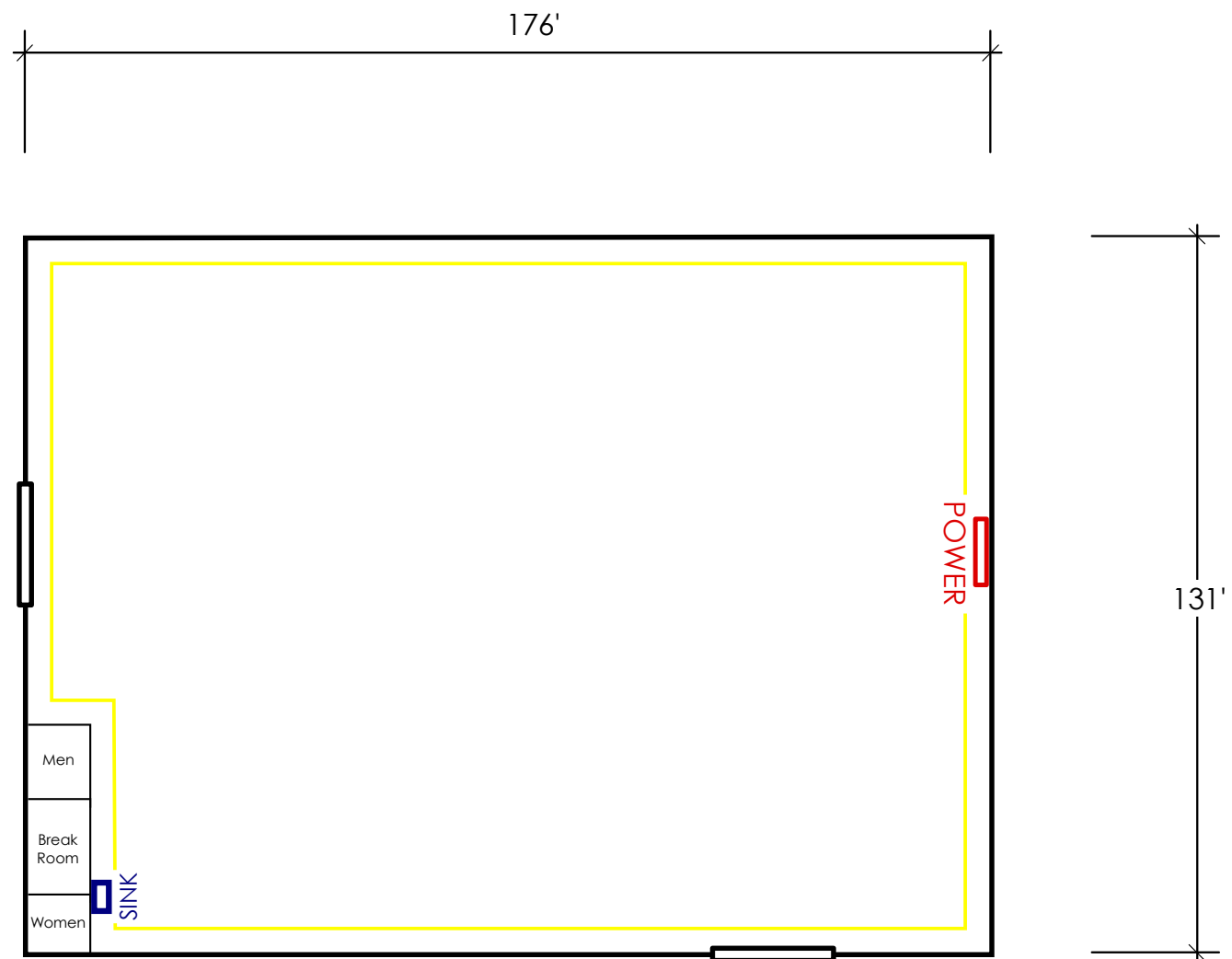

Fire Lane = 5' from walls
Area Inside Fire Lane = 19,500 Sq. Ft.



STAGE 7

1/32" = 1'

STAGE 8 THE SHANNON BUILDING

28,650 Square Feet
 Clearance - 39.5' Front, 29.5' Rear
 Power - 1600 Amps, 3-Phase
 Rafter Load: 10,000 lbs.
 Quiet A/C - 210 Tons
 Doors - 2, 20' x 20'
 Trailer Hookups - 10

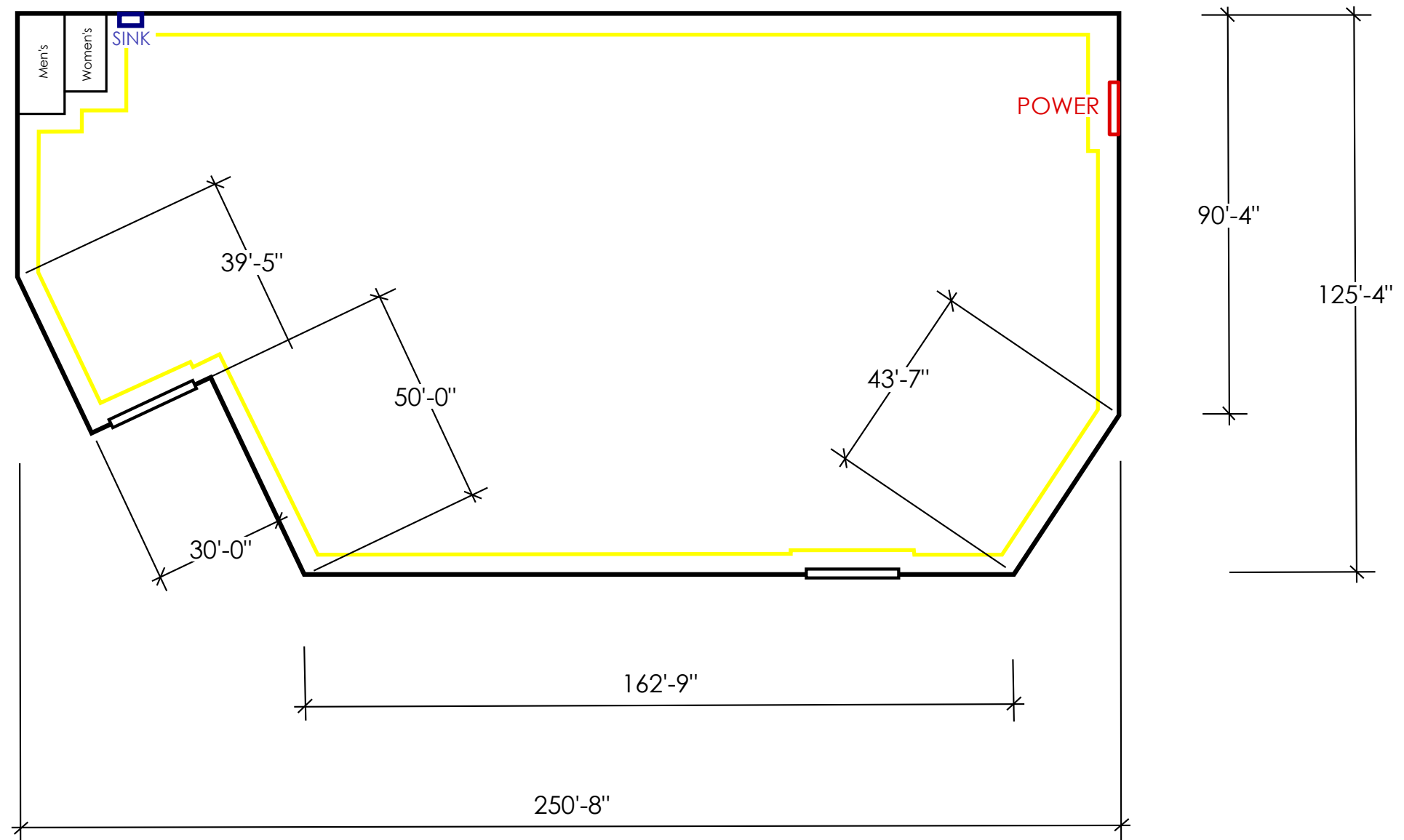

Fire Lane = 5' from walls
 Area Inside Fire Lane = 25,150 Sq. Ft.



STAGE 8

1/32" = 1'

25,000 Square Feet
Newly Remodeled,
Class-A Space
Independent or Joinable Suites
Fiber High-Speed Internet and
Campus Fiber Network
Digital Phone System

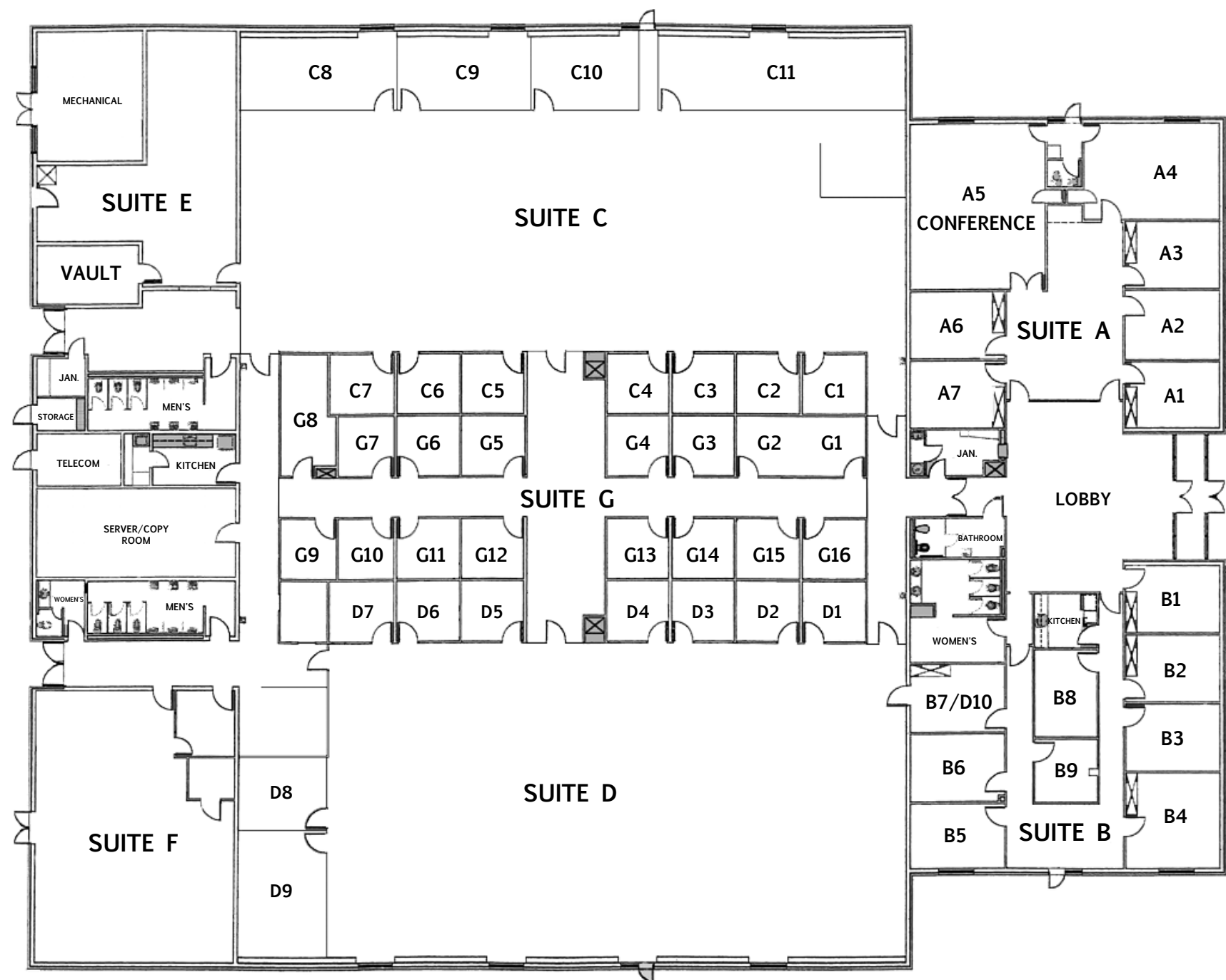

Celtic
MEDIA CENTRE

OAK TREE

$$3/64'' = 1'$$

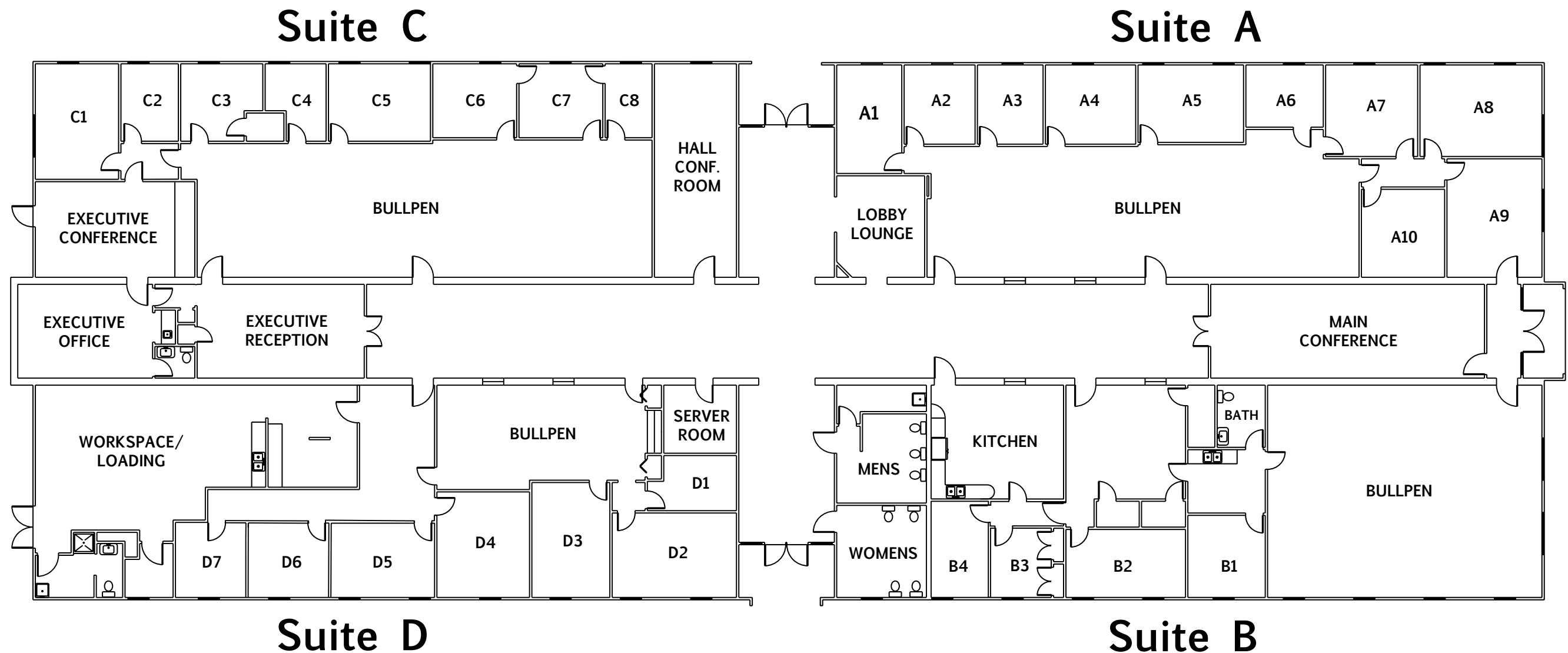

THE CYPRESS BUILDING PRODUCTION OFFICES

16,200 Square Feet
 Newly Remodeled, Class-A Space
 Independent or Joinable Suites
 Fiber High-Speed Internet and
 Campus Fiber Network
 Digital Phone System
 Dedicated Server Room



CYPRESS

1/16" = 1'

THE COTTAGE POST-PRODUCTION SUITES

3,044 Square Feet
Newly Remodeled, Class-A Space
Climate-Controlled Server Room
Fiber and Ethernet to Each Suite
Fiber High-Speed Internet and
Campus Fiber Network
Digital Phone System

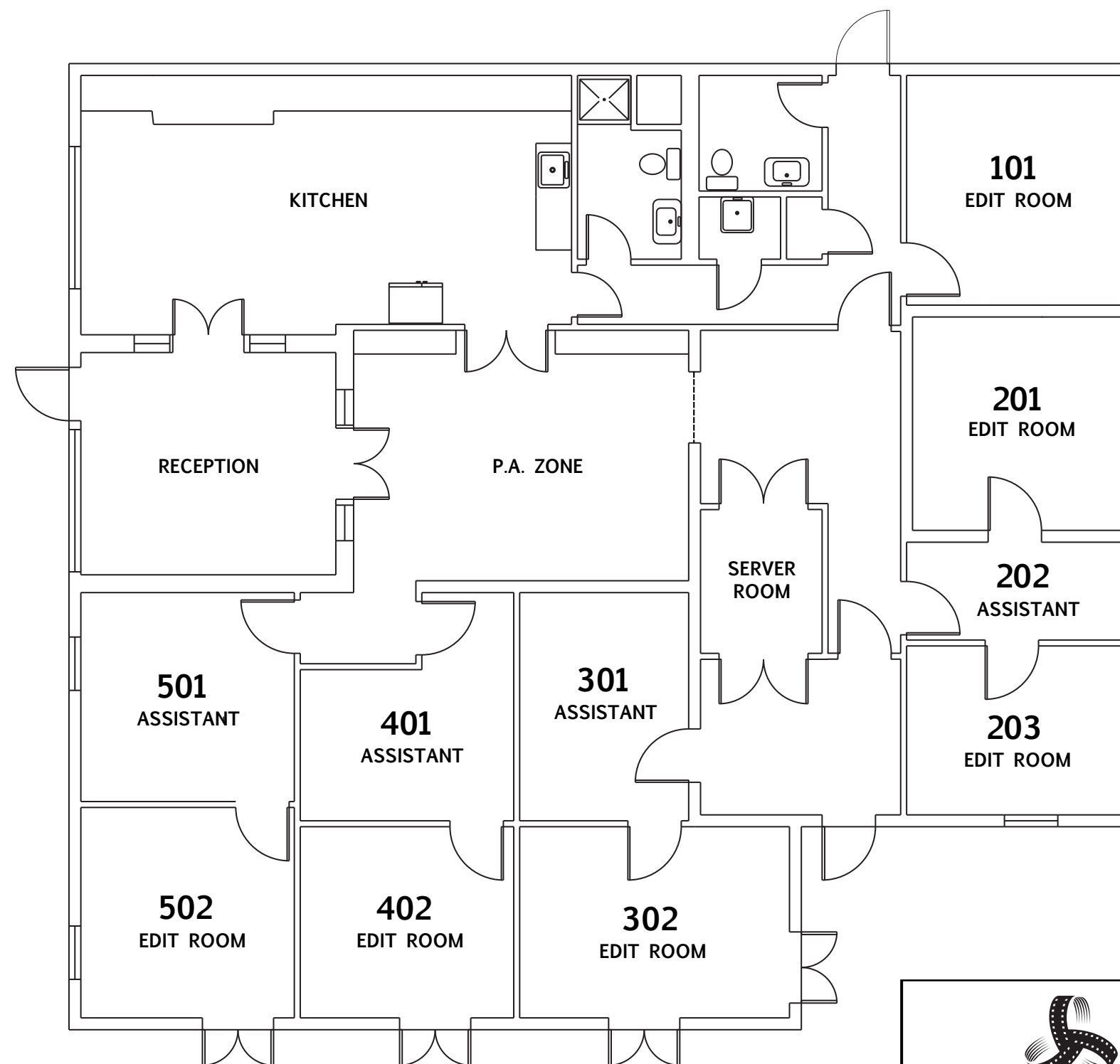

Celtic
MEDIA CENTRE

THE COTTAGE

1/8" = 1'